

Yealink

Headset YHS32



User Guide
Version 1.5

Components

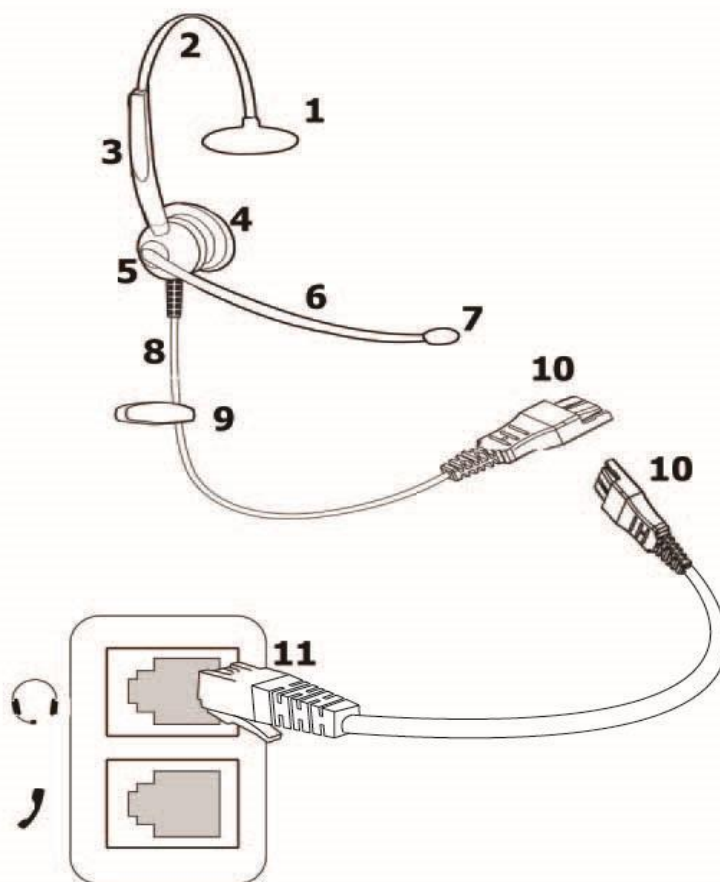

- 1. T-Bar (limited to one receiver product)
- 2. Adjustable Headband
- 3. Adjustment Rod

- 4. Ear Cushion
- 5. Click-Stop Turret
- 6. Boom
- 7. Microphone

- 8. Headset Cable
- 9. Clothing Clip
- 10. Quick Disconnectors
- 11. RJ9 Modular Connector

Connection

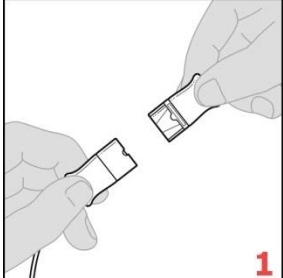
Figure	Description
 <p data-bbox="343 1906 367 1935">1</p>	<p data-bbox="406 1666 1455 1753">The headset is equipped with a quick disconnect. Users can connect the headset to a special adapter to connect to your IP phone.</p>

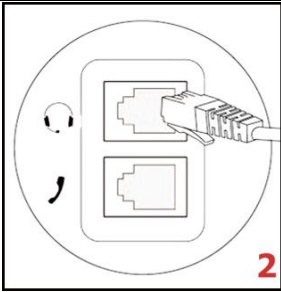

The headset is fitted with a standard modular connector.
To use the headset mode, simply insert the modular connector into the headset port of a compatible telephone.

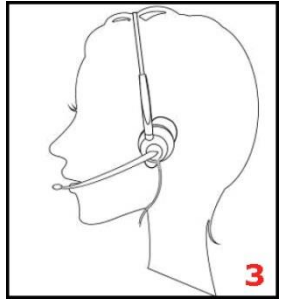

To adjust the headband, lengthen or shorten the adjustment rod until it fits comfortably. The click-stop feature keeps the headband securely adjusted. Position the headset receiver so that the foam cushions sit comfortably over the center of your ears.

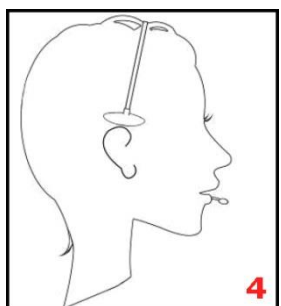

On models with only one receiver, position the T-bar above your ear.

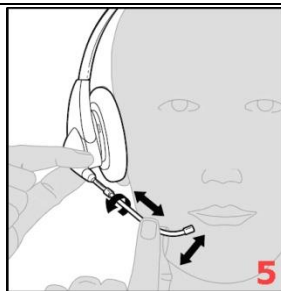

Hold the receiver securely against your ear with one hand. With the other hand, use the boom to adjust the microphone to about one finger distance to your lips.

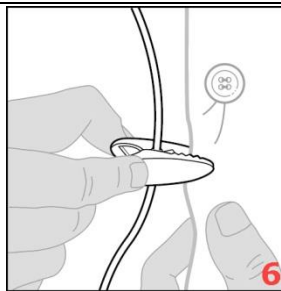

The clothing clip helps to keep the headset properly positioned and free from the cord's weight. Attach the clothing clip at a comfortable level to liberate your hand.

Usage

The Yealink YHS32 is compatible with all of the Yealink IP phones. We will take Yealink SIP-T28P IP phone as an example to make a brief description.

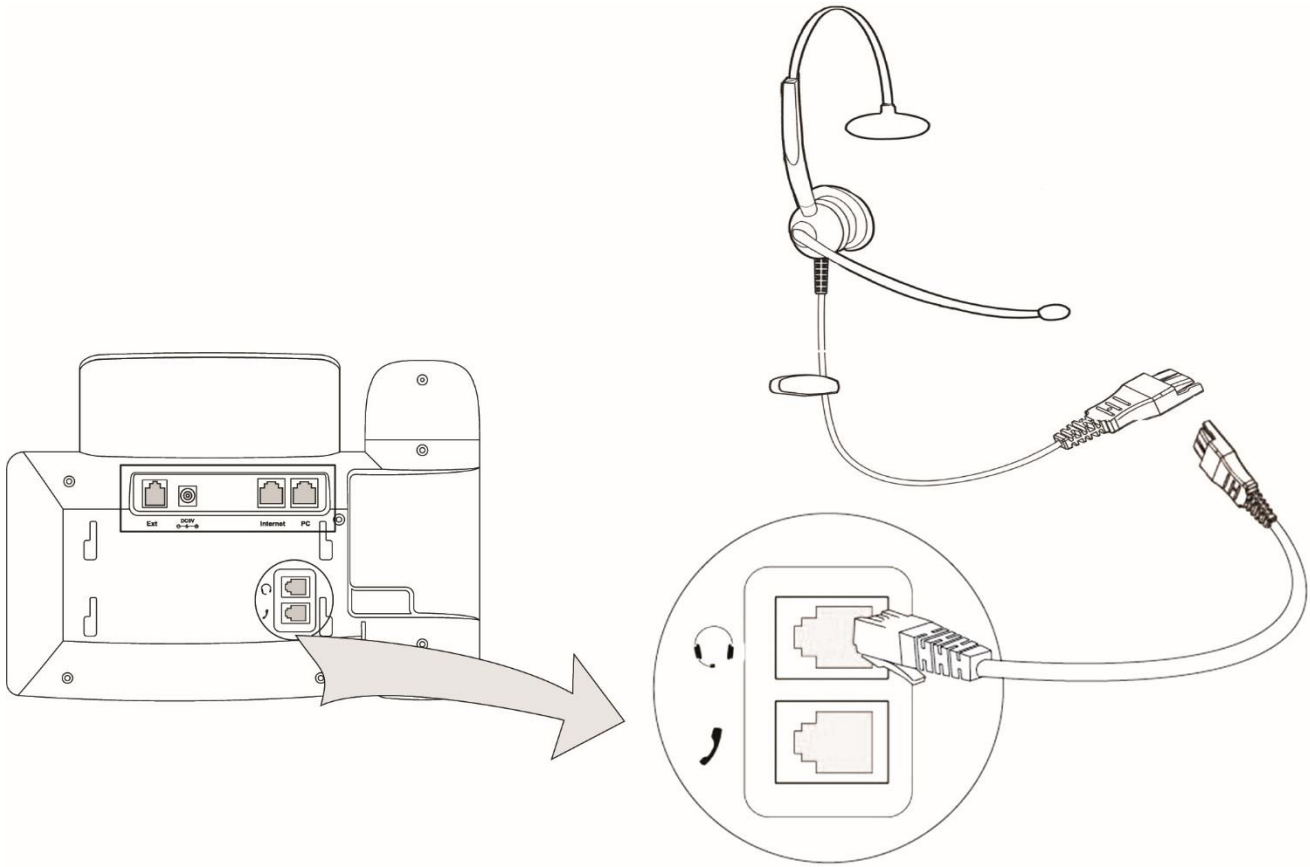

1. When an incoming call arrives to your extension, press the HEADSET key to answer it by the headset mode.
2. During a conversation, press the HEADSET key or pick up the handset, the conversion will switch between the headset mode and the handset mode.

Yealink(Xiamen) Network Technology Co.,Ltd.

309, 3th Floor, No.16, Yun Ding North Road, Huli District, Xiamen City, Fujian, P.R.C

YEALINK(EUROPE) NETWORK TECHNOLOGY B.V.

Address: WTC Schiphol Airport, B tower, 5th floor, Schiphol Boulevard 231, 1118 BH Amsterdam Schiphol, the Netherlands

YEALINK(USA) NETWORK TECHNOLOGY CO., LTD.

Address: Sutherland Asbill & Brennan LLP, 999 Peachtree Street NE, Atlanta, GA 30309-3996