



Yealink Network Technology CO., LTD

Yealink VC110 Video Conferencing Endpoint Quick Start Guide

V23.20

Applies to firmware version 50.23.0.20 or later

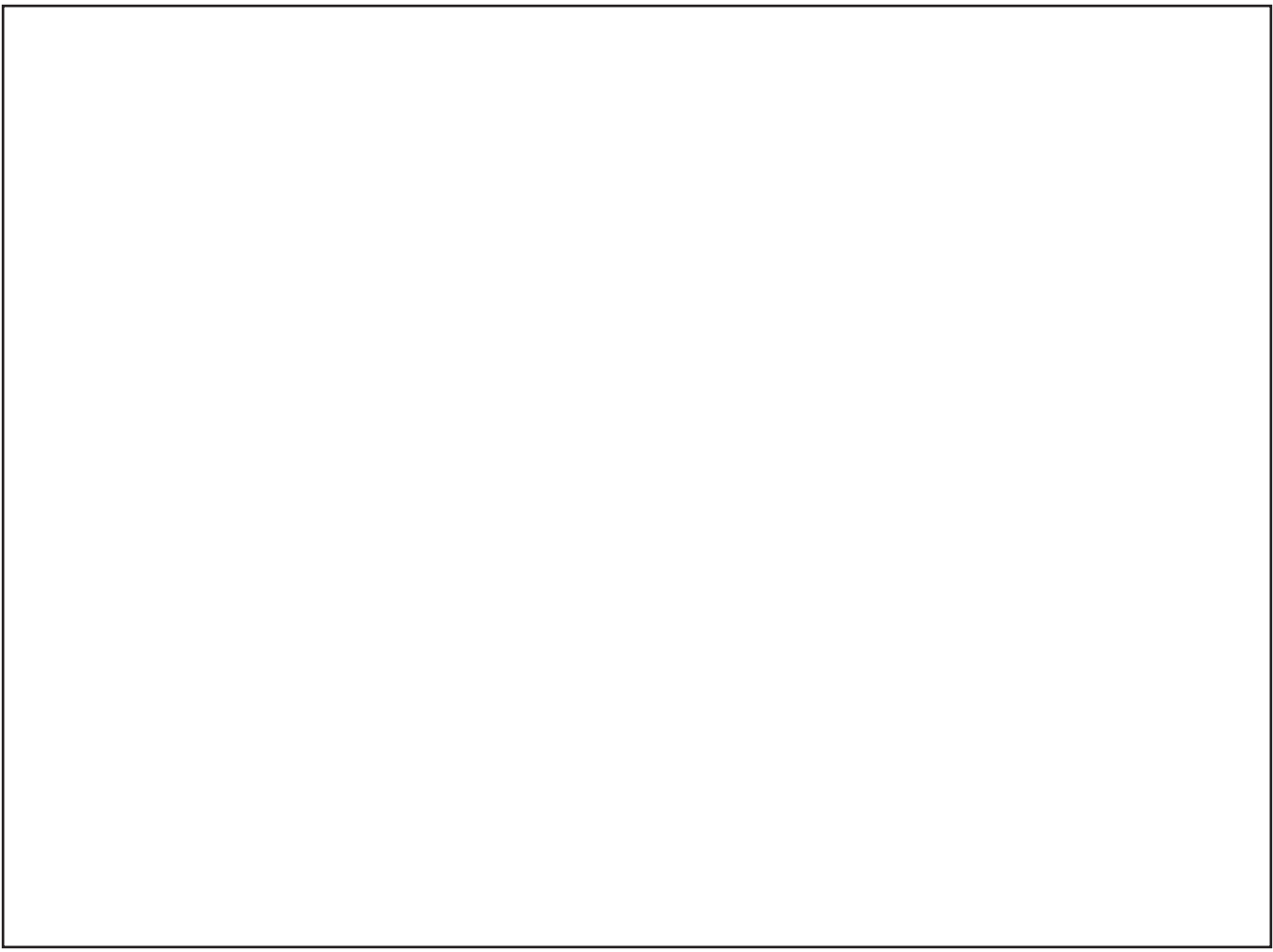

Table of Contents

Packaging Contents	01
VC110-All-in-one Unit Connection Diagram	02
Remote Control and Cable Ties Installation	04
VC110-All-in-one Unit Installation	05
Cable Hub Connection Diagram	07
Main Screen	08
Network Deployment	09
Troubleshooting	13



Packaging Contents



VC110 All-in-one Unit

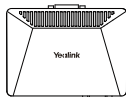

Cable Hub



Remote Control
AAA Batteries × 2

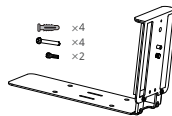

Mounting Bracket
and Accessories



Velcro × 2
(One Velcro is on the bracket)



Cable Ties × 5



HDMI Cable

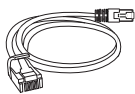

Ethernet Cable
(2m)



DVI Cable



HDMI-VGA Direct Cable

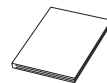

Quick Start Guide

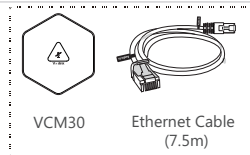

Microphone Array Package



Power Adapter



VCM60



Dongle



Power
Adapter



USB Cable



Quick Start
Guide



Video Conferencing
Phone



CPE80 Expansion
Microphone × 2



Ethernet Cable
(7.5m)



3.5mm Audio Cable

Wireless Microphone Package

Video Conferencing Phone Package



Please use the Yealink-customized DVI cable.



We recommend that you use the accessories provided or approved by Yealink. The use of unapproved third-party accessories may result in reduced performance.



VC110 all-in-one unit can work with the video conferencing microphone array, video conferencing wireless microphone or video conferencing phone. You can purchase any combination according to your needs.

VC110 All-in-one Unit Connection Diagram

- The Back of the VC110

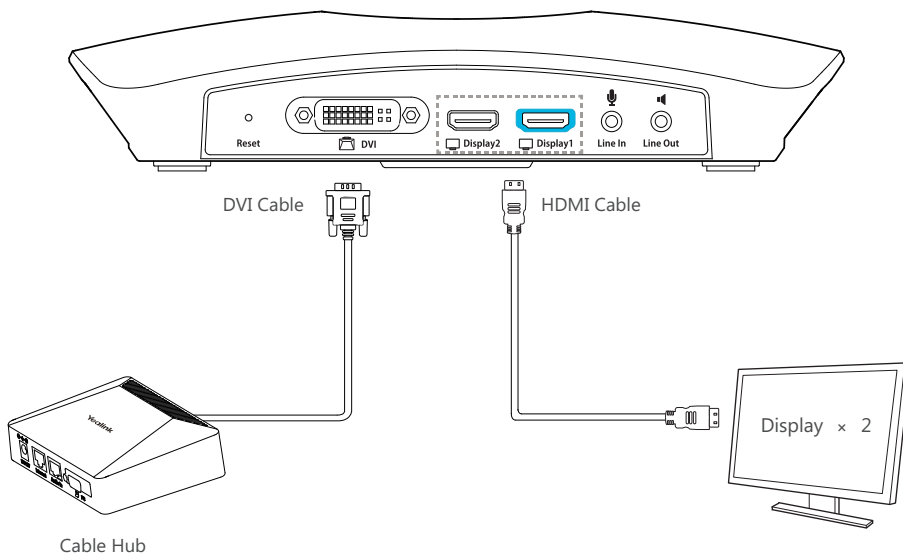

Please connect to Display1 port in blue color if you have only one display device

- The Right Side of the VC110

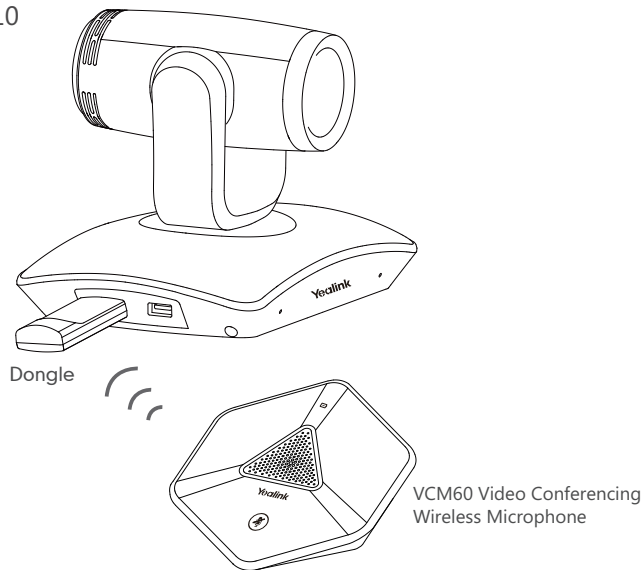

The VCM60 video conferencing wireless microphone and dongle are automatically “paired” at the factory. All you need to do is connect the dongle to one of the USB ports on the VC110 all-in-one unit. After the VCM60 is turned on, the VCM60 will register with the dongle automatically.



For more information, refer to [Yealink VCM60 Video Conferencing Wireless Microphone Quick Start Guide](#)

Remote Control and Cable Ties Installation

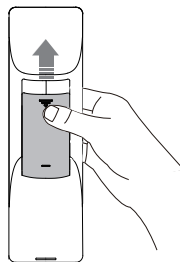
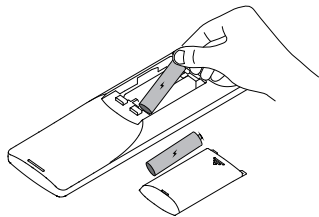

Install batteries

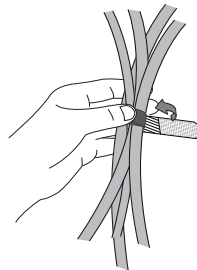
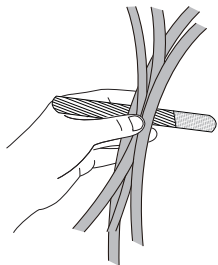

Fasten the cables with the cable tie

VC110 All-in-one Unit Installation

- Hanging Mode

Please choose the following installation mode when the thickness of the TV is between 35-120mm.

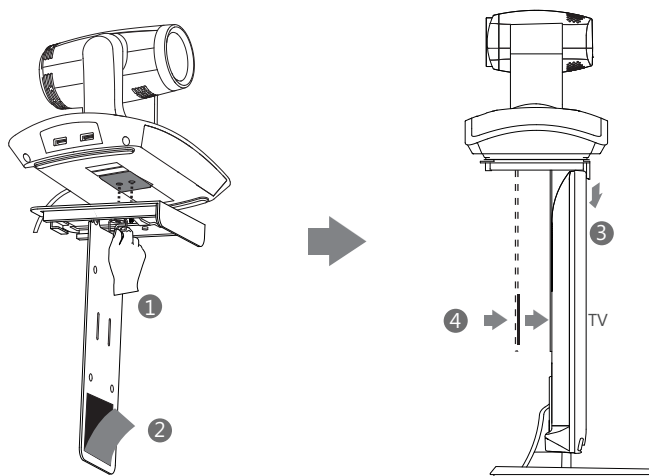

Steps: ① Lock the camera to the L-bracket. ② Remove one Velcro. ③ Put the L-bracket on the top of the TV.
④ Stick a Velcro onto the back of the TV, and make sure that the bracket and the back of the TV are tightly positioned against each other.

💡 The Velcro cannot be reused, so that make sure the back of the TV is clean before sticking a Velcro

● Wall-mount Mode

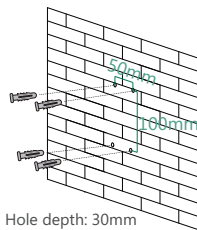

1

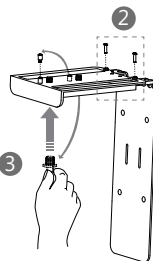

2

3

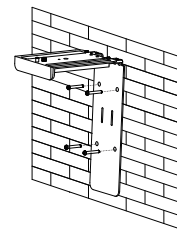

4

Screw specification: T4 x 30

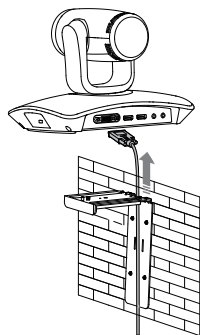

5

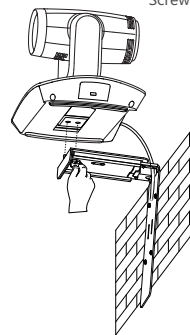

6

Steps : 1 Punch holes & Insert expansion bolts

2 Drive screws

3 Adjust the screw position and manually lock it

4 Insert screws to lock the bracket to the wall

5 Connect DVI cable

6 Lock the camera



The recommended height for VC110 all-in-one unit positioning is 1.5m-1.8m

Cable Hub Connection Diagram

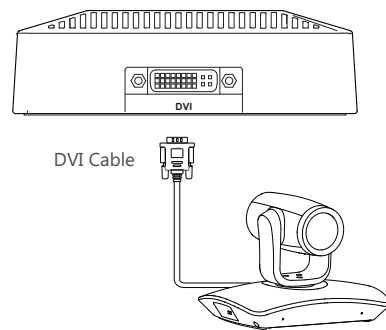
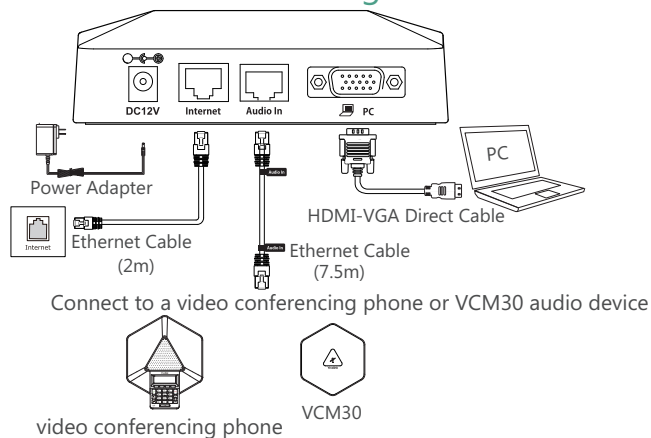

- 💡 The VC110 video conferencing endpoint should be used with Yealink original power adapter (12V/2A) only.
- 💡 The cable hub can also be powered from a PoE-compliant switch or hub.

Wall Mount Method for the Cable Hub

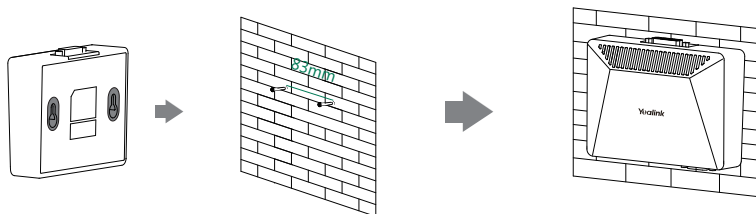

- 💡 To hang the cable hub on the wall, you need to purchase the screws (specification: T4 × 30) separately.

Main Screen

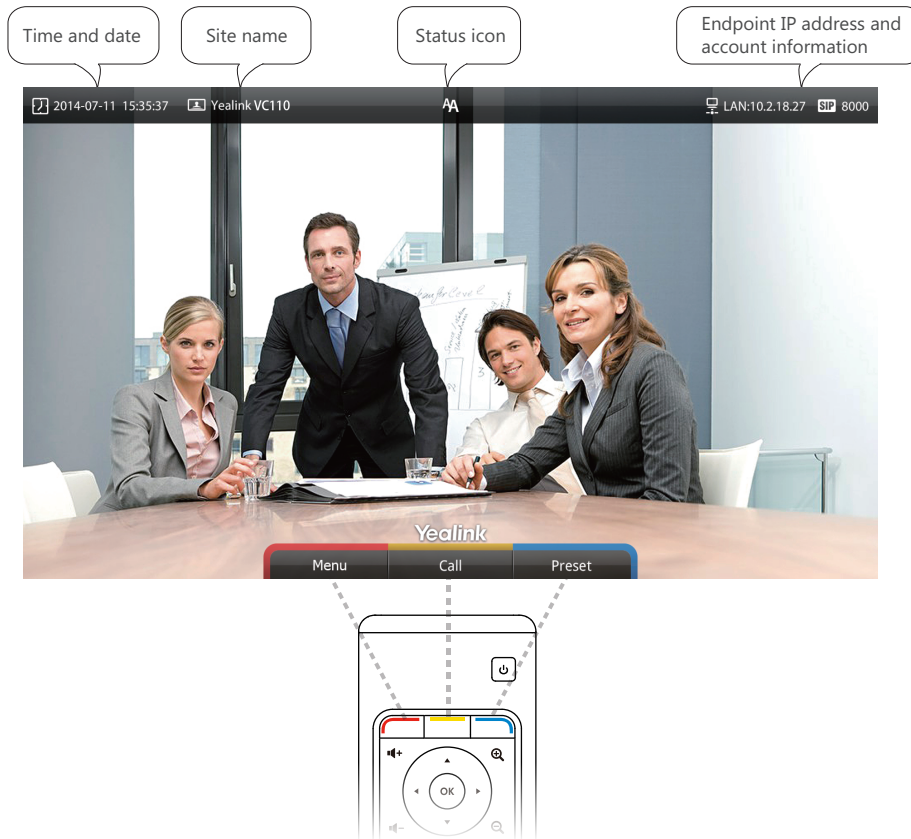

Network Deployment

VC110 supports two network deployment methods: Cloud deployment and traditional deployment. Choose the desired deployment method according to your needs.

- **Cloud Deployment**

With Cloud service, organizations can communicate using the Cloud platform, so that complex network settings are unnecessary. You can log into Yealink VC Cloud Management Service/Yealink Meeting Server/StarLeaf/Zoom/Pexip/BlueJeans/Mind platform using VC110 video conferencing endpoint. Get account information from your administrator.

Do the following to log into your VC110 via remote control:

- Select **Menu->Advanced** (Default Admin Password:0000)-> **Video Conference Platform**.
- In the **Cloud Account** field, check the **Enabled** checkbox.
- Select the desired platform from the pull-down list of **Platform Type**.

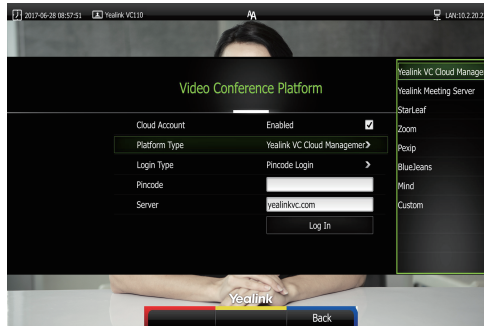

- Configure the desired platform and log in.

● Traditional Deployment

If you do not log into the Cloud platform, you can choose traditional deployment method to deploy your VC110, and dial the IP address of other device to make a call.

In order to ensure that the VC110 can work properly, please configure it according to the actual situation.

If it is in the head office, please make sure that it is reachable from public network. If it is in the branch office, please use intelligent traversal to deploy it or just follow the same steps as for the head office.

Head Office

If you deploy VC110 in the head office, at least one static public IP address is required in the head office to allow branch offices to connect. Do one of the following to deploy VC110:

Option1: To deploy the VC110 on a public network, at least one static public IP address is required, you need to assign a static public IP address to the VC110.

Option2: To deploy the VC110 in an Intranet (behind the firewall), you must assign a static private IP address to the VC110. In the meantime, do port mapping on the firewall for VC110.

Configure a Static IP

The following introduces how to configure a static IP address for the VC110.

For example: use the remote control to configure a static IPv4 address to your VC110.

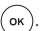
- Select **Menu->Advanced** (Default Admin Password:0000)->**Internet Configuration**.
- Select **IPv4** from the pull-down list of **IP Mode**.
- Press ▲ or ▼ to scroll to **IPv4**, and then press .
- Turn off the **DHCP**.

- Enter the IP address, subnet mask, gateway and DNS information in corresponding fields.

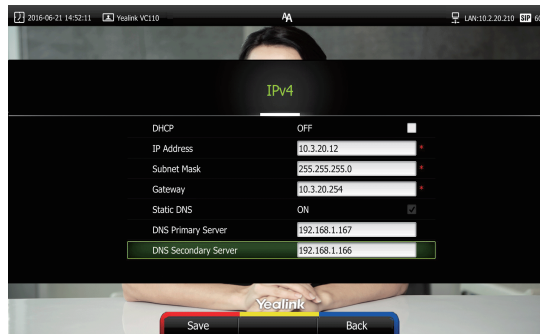

- Press **Save** to save the configuration.
- The screen prompts **Reboot now** . Press **OK** to reboot the endpoint.

Configure Port Mapping

If the VC110 is deployed in an Intranet, and you want to solve the interconnection problem by port mapping, you must forward the following ports to the public network on the firewall.

Function	Port	Protocol Type
H.323 signal port	1719-1720	UDP/TCP
Audio & Video media stream port	50000-50499	TCP/UDP
Web management port (optional)	443	TCP
SIP (optional)	5060	TCP/UDP

Branch Office

If you deploy VC110 in the branch office, do one of the following to deploy it:

Option1: Deploy the VC110 following the same steps as for the head office. In this way, both inbound and outbound calls are available.

Option2: Deploy the VC110 using intelligent traversal, which means that plug and play is possible without any further firewall configuration, but only outbound calls are available.



Please note that when the VC110 is deployed with intelligent traversal, you have to open ports (as shown below) if they are restricted.



It is recommended that you forward the web management port(443/TCP) to the public network, so that the head office can remotely manage the branch office.

Function	Port	Protocol Type
H.323 signal port	1719-1720	UDP/TCP
Audio & Video media stream port	50000-50499	TCP/UDP
SIP (optional)	5060-5061	TCP/UDP

Bandwidth Requirements

- To ensure the performance of video conference, the recommended bandwidth for VC110 is as below:

Video Resolution	Recommended Bandwidth
Full HD 1080P	1.3Mb
People 1080P+Content 1080P	2.6Mb



For more information of the configurations, contact your system administrator.



The bandwidth mentioned above is based on two-way conference. Bandwidth in head office should be increased along with the growing number of connected branch offices .

Troubleshooting

- After installation and deployment, you can test the VC110 by dialing the Yealink Demo Room. If you cannot dial out successfully, please contact your IT administrator to check the internal network configuration.
- If you do not use Cloud platform and deploy your VC110 in an Intranet, you have configured port mapping on the firewall or gateway, but you find that local system appears black screen and you cannot hear sound when you call Yealink Demo or other systems. The most likely reason is that the firewall or gateway in your environment does not support the H.323 ALG feature. In this situation, please take the following actions so that the NAT feature on the VC110 can solve this problem.

To configure NAT via the remote control:

- Select **Menu->Advanced** (Default Admin Password:0000)->**NAT/Firewall**.
- Select **Auto** from the **Type** pull-down list, the endpoint will obtain public IP address automatically.
- If the endpoint does not obtain a public IP address automatically, select **Manual Settings** from the **Type** pull-down list, and then enter the public IP address in the **Public IP Address** field.

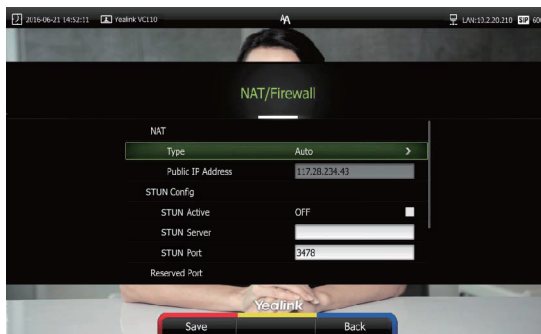

Yealink Demo Room IP: 117.28.251.50、 117.28.251.51

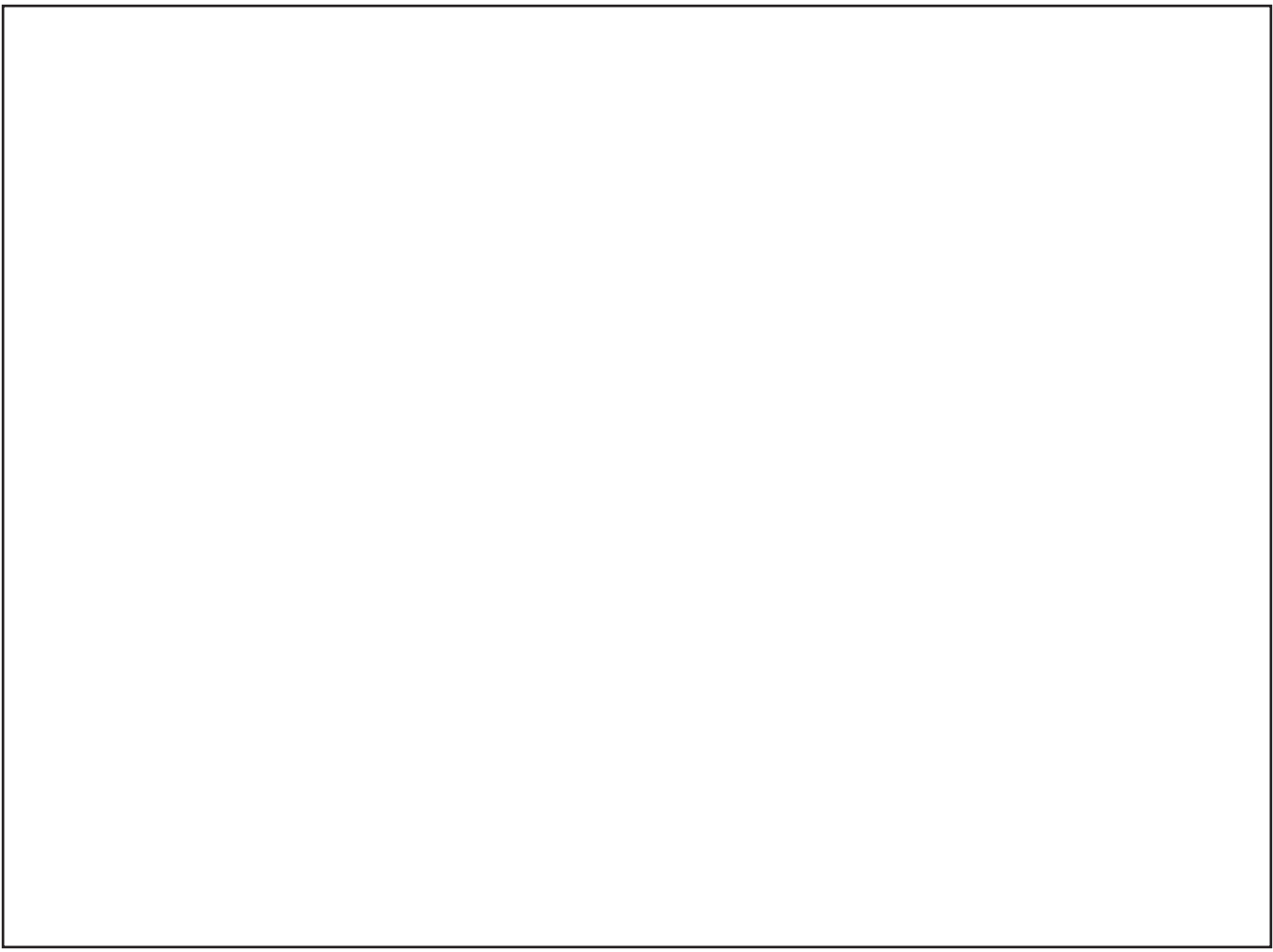



For more information, visit the Yealink website:
www.yealink.com



VC110-EN

YEALINK(XIAMEN) NETWORK TECHNOLOGY CO.,LTD.

Web: www.yealink.com | Addr: 309, 3th Floor, No.16, Yun Ding North Road, Huli District, Xiamen City, Fujian, P.R. China

Copyright©2017YEALINK(XIAMEN) NETWORK TECHNOLOGY CO.,LTD. All rights reserved.

