

# Enabling the Developer Mode for Yealink T5 Smart Business Phone Series

## Introduction

Before using the Yealink’s SDK, you should enable Android’s built-in developer mode first. This guide provides detailed information on how to enable/disable the developer mode. Developer mode is available for SIP-T58A IP phones.

## Enabling the Developer Mode

To enable the Developer mode:

1. Add/Edit system mode parameter in the configuration file (e.g., app.cfg).

The following table lists the information of parameter:

Parameter	Permitted Values	Default
<b>custom.static.system_mode_selection</b>	<b>0 or 1</b>	<b>0</b>
<p><b>Description:</b>                      Enables or disables the IP phone to display the system mode selection box after startup.  <b>0</b>-Disabled  <b>1</b>-Enabled. After startup, you can tap <b>Developer mode</b> from the system mode selection box to enable the developer mode.  <b>Note:</b> You need to manually reboot the IP phone to make the change take effect.</p>		

The parameter setting in the configuration file for reference is shown as below:

custom.static.system\_mode\_selection=1

2. Reference the configuration file in the boot file (e.g., y000000000000.boot).

Example:

include:config "http://192.168.10.25/app.cfg"

3. Upload the boot file and configuration file to the root directory of the provisioning server.
4. Trigger IP phones to perform an auto provisioning for configuration update.

For more information on auto provisioning, refer to [Yealink SIP IP Phones Auto Provisioning Guide](#).

5. Reboot the IP phone.

After restart, the IP phone will display the system mode selection box:

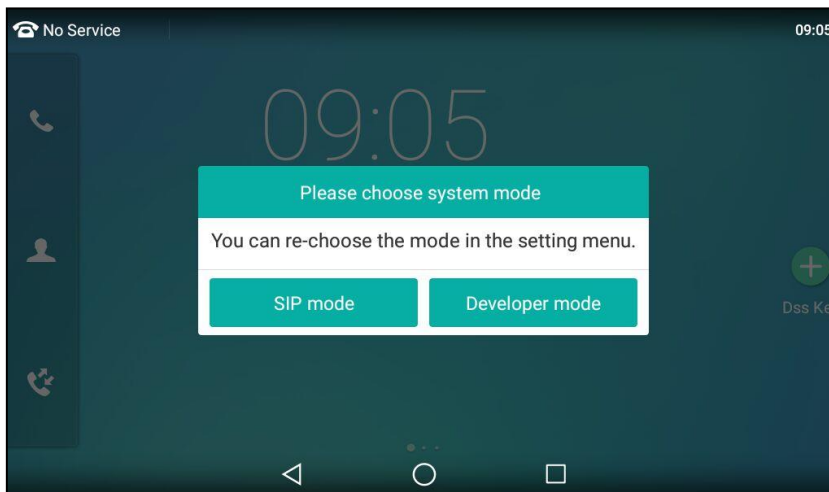

6. Tap **Developer mode**.

The IP phone will reboot to make the change take effect.

## Disabling the Developer Mode

You can disable the developer mode by resetting the IP phone to factory settings.

**To reset the IP phone to factory settings via phone user interface:**

1. Swipe down from the top of the screen or swipe left/right to go to the second idle screen.
2. Tap **Settings->Advanced** (default password: admin) ->**Reset Config**.

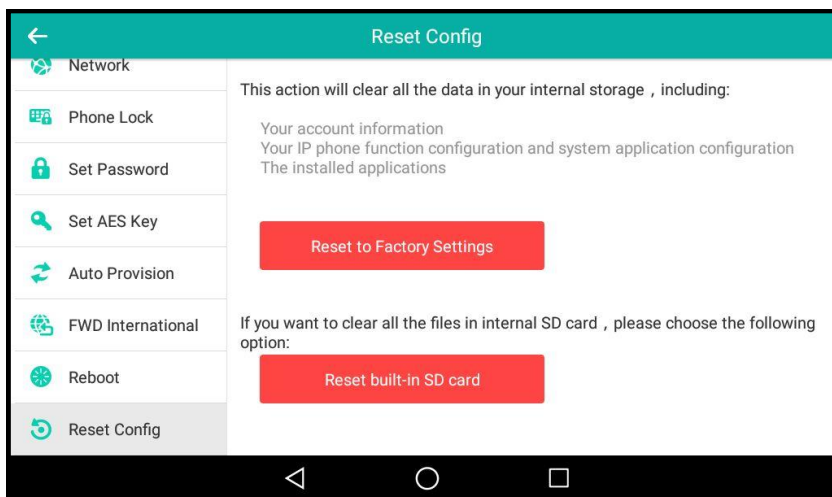

3. Tap **Reset to Factory Settings**.

The touch screen prompts the following warning:

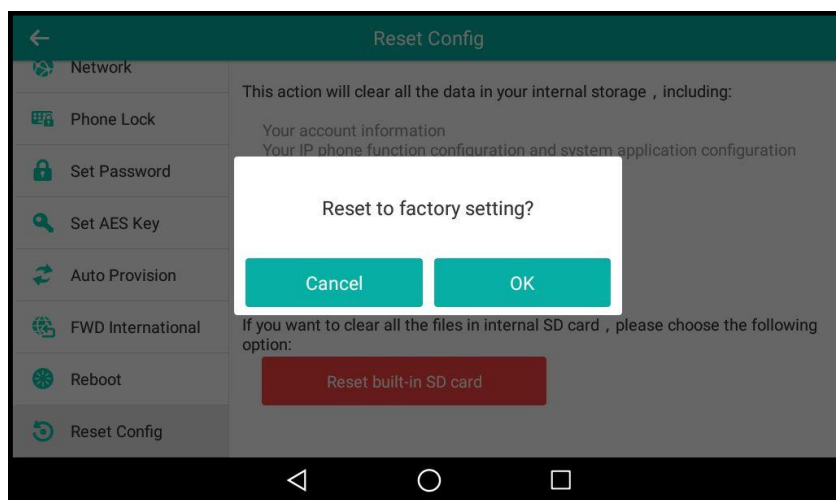

4. Tap **OK**.

The phone begins resetting.