

Yealink

Wall Mount Quick Installation Guide for SIP-T40/T41/T42 IP Phones (V1.2)

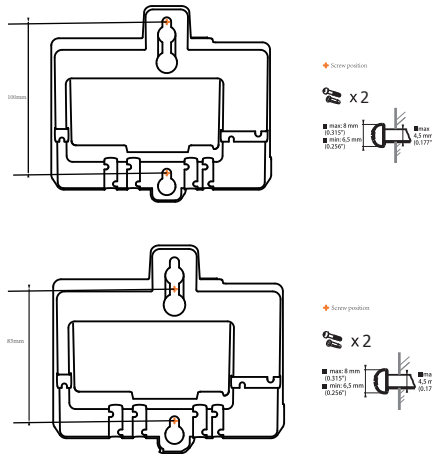

You can also download the wall mount drilling template online:

<http://www.yealink.com/Support.aspx>.

Following the drilling template above, you can mount the IP phone to the wall, as shown below:

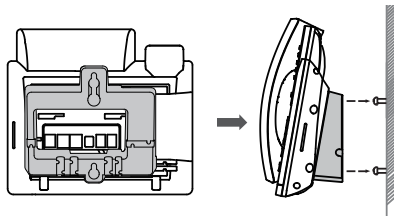

This quick installation guide provides step-by-step instructions for mounting your IP phone to a wall. Wall mount is available for the following IP phones:

- SIP-T40P IP Phone
- SIP-T41S/T41P IP Phone
- SIP-T42S/T42G IP Phone

The wall mount bracket is required for wall mount installation, which is not included with your IP phone, contact your reseller to purchase it separately.

Packaging Contents

The following items are included in your package. If you find anything missing, contact your system administrator.

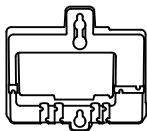

Wall Mount Bracket Quick Installation Guide

Wall anchors and applicable tools not included in your package are also required for wall mount installation.

Adjusting the Hookswitch Tab

The IP phone is packaged with the hookswitch tab in desk mount position. Before mounting the IP phone to a wall, you must set the hookswitch tab to wall mount position.

To adjust the hookswitch tab:

1. Pull the hookswitch tab in the handset cradle.
2. Rotate the hookswitch tab 180 degrees.
3. Reinsert the hookswitch tab.

Adjust the hookswitch tab as shown below:

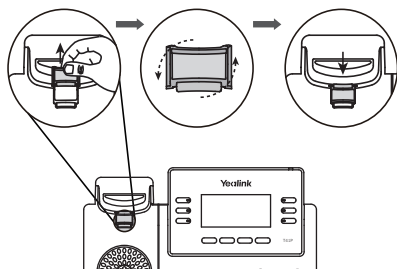

The hookswitch tab has a lip which allows the handset to stay on-hook when the IP phone is mounted vertically.

Attaching the Wall Mount Bracket

To attach the wall mount bracket:

Insert the tabs on the wall mount bracket into the slots on the back of IP phone. And then slide the wall mount bracket to right.

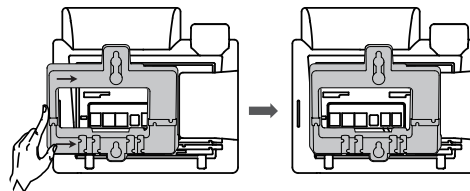

Mounting the Wall Mount Bracket

Yealink provides two kinds of the wall mount drilling templates, which locate and mark the position for mounting the screws (not provided) on the wall, as shown below: