

Wall Mount Quick Installation Guide for SIP-T29_T27_T4X_T5X IP Phones

This quick installation guide provides step-by-step instructions for mounting your IP phone to a wall.

Wall mount is available for the following IP phones:

- SIP-T58V/T58A/T56A/T54S/T52S IP Phones
- SIP-T48S/T48G/T46S/T46G IP Phones
- SIP-T29G/T27P/T27G IP Phones

The wall mount bracket is required for wall mount installation, which is not included with your IP phone, contact your reseller to purchase it separately.

Packaging Contents

The following items are included in your package. If you find anything missing, contact your system administrator. (Purchase the proper package according to the IP phone model you own.)

Available for a SIP-T58V/T58A/T56A/T54S/T52S IP phone:

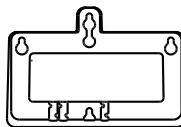

Wall Mount Bracket

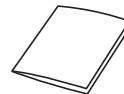

Quick Installation Guide

Available for a SIP-T48S/T48G IP phone:

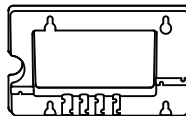

Wall Mount Bracket

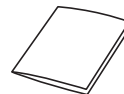

Quick Installation Guide

Available for a SIP-T46S/T46G IP phone:

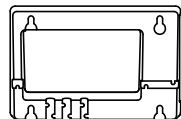

Wall Mount Bracket



Quick Installation Guide

Available for a SIP-T29G/T27P/T27G IP phone:

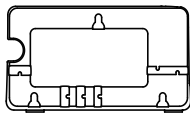

Wall Mount Bracket

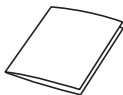

Quick Installation Guide

Wall anchors and applicable tools not included in your package are also required for wall mount installation.

Adjusting the Hookswitch Tab

The IP phone is packaged with the hookswitch tab in desk mount position. Before mounting the IP phone to a wall, you must set the hookswitch tab to wall mount position.

To adjust the hookswitch tab:

1. Pull the hookswitch tab in the handset cradle.
2. Rotate the hookswitch tab 180 degrees.
3. Reinsert the hookswitch tab.

Adjust the hookswitch tab as shown below(Take a SIP-T46G IP phone as an example):

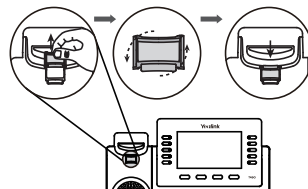

The hookswitch tab has a lip which allows the handset to stay on-hook when the IP phone is mounted vertically.

Attaching the Wall Mount Bracket

To attach the wall mount bracket:

1. Pull silica gels out of the two wall mount slots. (Only for the SIP-T48S/T48G IP Phones)

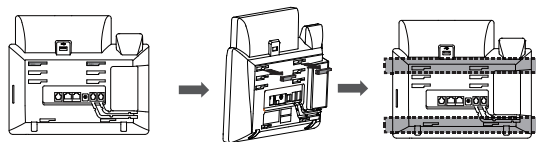

2. Insert the tabs on the wall mount bracket into the slots on the back of IP phone. And then slide the wall mount bracket to right.

For a SIP-T58V/T58A/T56A/T54S/T52S IP phone:

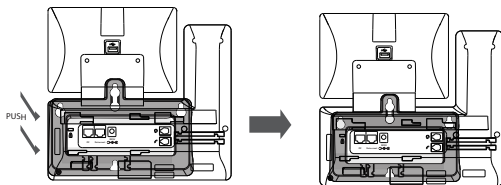

For a SIP-T48S/T48G/T29G/T27P/T27G IP phone:

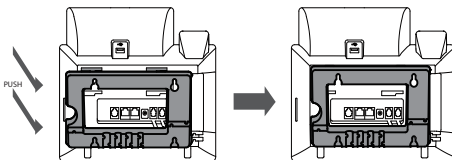

For a SIP-T46S/T46G IP phone:

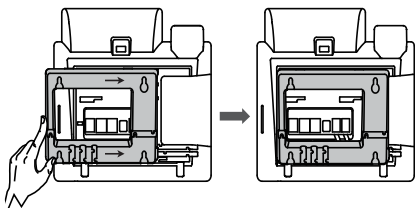

Mounting the Wall Mount Bracket

Yealink provides the wall mount drilling template for each IP phone model, which locates and marks the position for mounting the screws (not provided) on the wall, as shown below:

For a SIP-T58V/T58A/T56A/T54S/T52S IP phones:

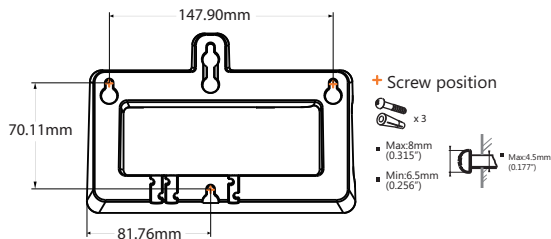

For a SIP-T48S/T48G IP phone:

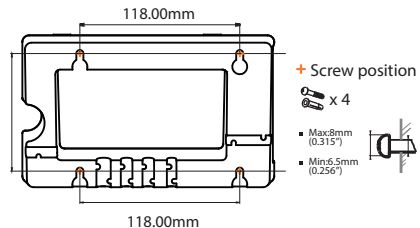

For a SIP-T46S/T46G IP phone:

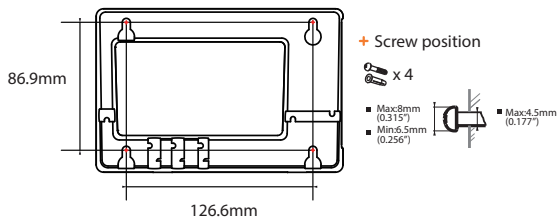

For SIP-T29G/T27P/T27G IP phone:

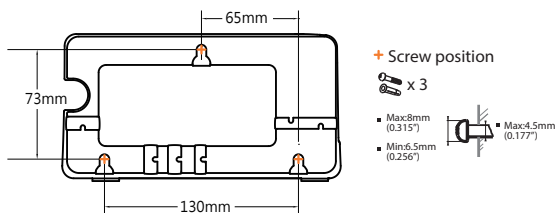

You can also download the wall mount drilling template online: <http://www.yealink.com/Support.aspx>.

Following the drilling template above, you can mount the IP phone to the wall, as shown below (Take a SIP-T46G IP phone as an example):

